

TLA / TLB SERIES

Standard specifications

Type A

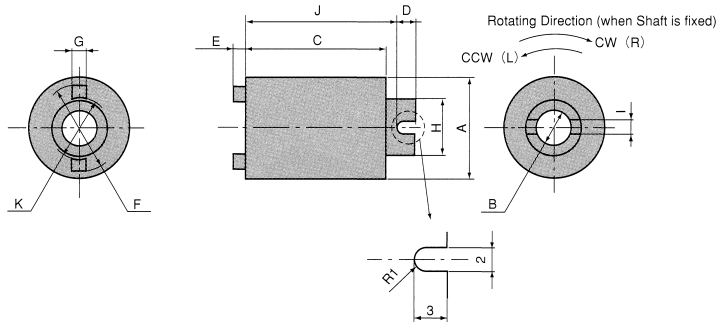

Code	Part No.	Application shaft [mm]	(70min ⁻¹) Torque [mN·m] (gf·cm)	Rotating Direction	Basic dimensions [mm]										
					A	B	C	D	E	F	G	H	I	J	K
510127	TLA9-618-250L	φ 6	24.5 (250)	CCW	φ 18	φ 6	25	3	2.5	φ 15	2.5	φ 10	2	26.5 ^{+0.5}	φ 10.5
510128	TLA9-618-250R			CW											
510129	TLA10-818-500L	φ 8	49 (500)	CCW	φ 18	φ 8	25	3	2.5	φ 15	2.5	φ 10	2	27 ^{+0.25} _{-1.0}	φ 10.5
510130	TLA10-818-500R			CW											
510131	TLA11-825-600L	φ 8	58.8 (600)	CCW	φ 25	φ 8	28	3	2.5	φ 15	2.5	φ 11	2	(30)	φ 11.5
510132	TLA11-825-600R			CW											

Rotating direction should be uni-directional, CW or CCW only.

Torque range requirements can be modified to meet your requirements, please consult with our sales/engineering department for assistance.

Type	Allowable range
TLA 9 Type	19.6mN·m~58.8mN·m (200 gf·cm~600 gf·cm)
TLA10 Type	19.6mN·m~58.8mN·m (200 gf·cm~600 gf·cm)
TLA11 Type	58.8mN·m~98.0mN·m (600 gf·cm~1000 gf·cm)

Type B

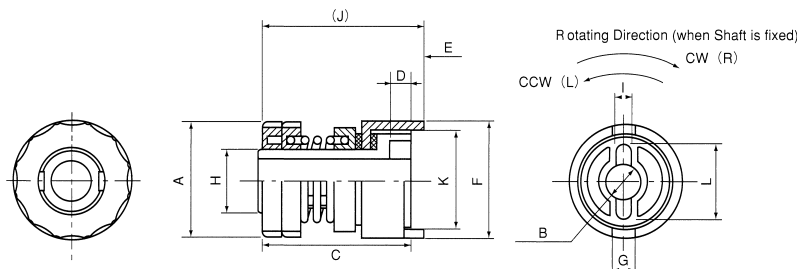
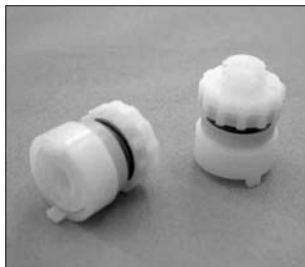

Code	Part No.	Application shaft [mm]	(70min ⁻¹) Torque [mN·m] (gf·cm)	Rotating Direction	Basic dimensions [mm]											
					A	B	C	D	E	F	G	H	I	J	K	L
520104	TLB1-618-300L	φ 6	29.4 (300)	CCW	φ 18	φ 6	23	3	2 ^{±0.3}	φ 18	3	φ 10	2.2	(25)	φ 15	12
520105	TLB1-618-300R			CW												

Rotating direction should be uni-directional, CW or CCW only.

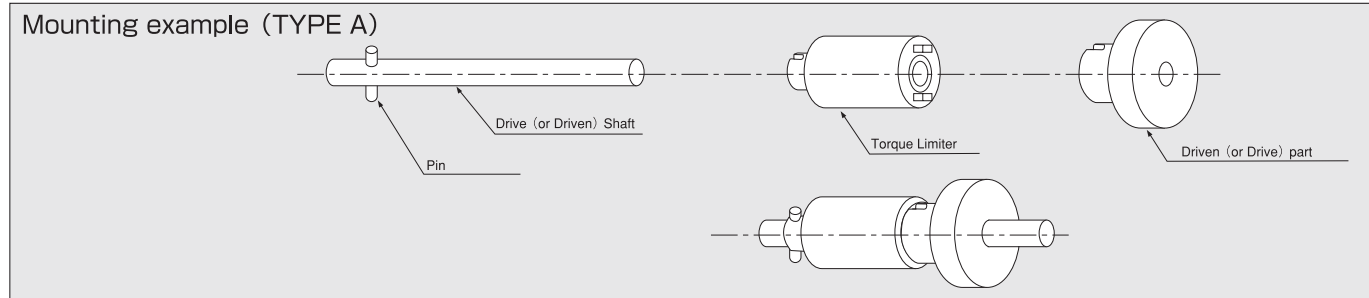

TOK BEARING CO.,LTD.

HEAD OFFICE, TOKYO, JAPAN – TEL : 81-3-3969-1534 FAX : 81-3-3969-9354
EMAIL : overseas@tok-bearing.co.jp

Product specification are subject to change without prior notice.

Before assembly or use of any bearing, please read "Caution for Use"